

CONTAINERS

URISAFE®*Uniquely designed to be
the most user friendly***24HR URINE COLLECTION CONTAINER**

B350-4L

Patented

B350

- 1 The unique snap valve pour spout is easily popped open and offers dripless pouring.
- 2 Specially designed leakproof screw cap with liner for safer transport.
- 3 Large centrally located handle for good balance and ease of manipulation.
- 4 Metal free and resistant to hydrochloric acid.
- 5 In regular position, sample volume can be read in 100 ml increments.
- 6 Place container in upright position and read in 50 ml increments.
- 7 Large 79 mm opening for ease of sample collection.

The patented **URISAFE® Urine Collection Containers** are **USER FRIENDLY** to both patients and laboratory personnel. Two sizes are available: a 3-liter, and a 4-liter size.

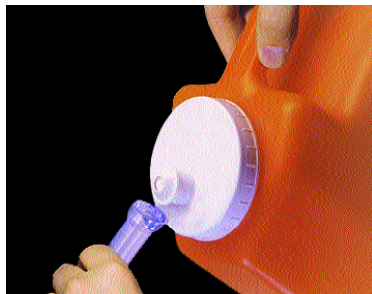

On the 4 liter model, urine can be poured into a tube by simply tilting the container forward without having to lift it.

The innovative cap:

- Snap valve pouring spout incorporated
- Leakproof: a cap liner ensures safe sample transport
- Large 79 mm opening for ease of sample collection

The unique snap valve pour spout:

- Easily popped open or pushed shut
- Offers dripless pouring
- Controlled flow rate for better handling of poured volumes
- Reduced risks of aerosol contamination when pouring
- Eliminates splashing and exposure to hazardous body fluids

Low form design:

- Convenient refrigerator storage with less wasted space.
- Anatomically designed for ease of patient use.

Large central handle:

- Can be gripped comfortably with three fingers
- Permits pouring off of samples with ease and reduces fatigue

Chemically resistant:

- Metal, latex, zinc and fluorescence free
- Resistant to hydrochloric acid. Made entirely of polypropylene and polyethylene
- Can be subjected to freezing, thawing and EtO gas sterilisation without causing changes in materials or physical appearance

Graduated vertically and horizontally:

- Both scales are accurate and easy to read
- Place container on end and read in 50 ml increments
- In regular position 100 ml graduations are for rough verification
- Eliminates transfer to graduated cylinder for volume measurement

Cat. #	Vol. (Liters)	Dimensions (cm)	Qty/Cs
B350	3	11.5 x 24.5 x 16.0 H.	40
B350-4L	4	11.5 x 24.5 x 20.1 H.	30



URITAINER™ 24HR URINE COLLECTION CONTAINER

- 1 The unique snap valve pour spout is easily popped open and offers dripless pouring.
- 2 Specially designed leakproof screw cap with liner for safer transport.
- 3 Metal free and resistant to hydrochloric acid.
- 4 Large 79 mm opening for ease of sample collection.
- 5 Large handle can be gripped comfortably with three fingers.
- 6 Volume level read in 50 ml increments.

This more conventional style urine bottle is available in 2 sizes: 2.5L and 3.5L. However, it incorporates some of the great features of the URISAFE 24 Hr urine collection container.



For all models, the unique snap valve pour spout is easily popped open and offers dripless pouring.

Cat. #	Vol. (Liters)	Dimensions (cm)	Qty/Cs
B360-25	2.5	33.3 x 13.3 x 23.2 H.	40
B360-35	3.5	33.3 x 13.3 x 29.5 H.	24

The innovative cap:

- Snap valve pouring spout incorporated
- Leakproof: a cap liner ensures safe sample transport
- Large 79 mm opening for ease of sample collection

The unique snap valve pour spout:

- Easily popped open or pushed shut
- Offers dripless pouring
- Controlled flow rate for better handling of poured volumes
- Reduced risks of aerosol contamination when pouring
- Eliminates splashing and exposure to hazardous body fluids

Large central handle:

- Can be gripped comfortably with three fingers
- Permits pouring off of samples with ease and reduces fatigue

Chemically resistant:

- Metal and latex free
- Zinc and fluorescence free
- Resistant to hydrochloric acid. Made entirely of polypropylene and polyethylene
- Can be subjected to freezing, thawing and EtO gas sterilisation without causing changes in materials or physical appearance

Labels for URISAFE® & URITAINER™ Containers

Three optional labels are offered

- Patient Identification Label.
- Patient Instruction Label.
- Caution Label.

Cat. #	Description	Qty/Roll	Qty/Pk
B350-4	Patient Identification label	100	1000
B350-5	Patient Instruction label	100	1000
B350-6	Caution label	100	1000

PATIENT AND TEST INFORMATION FOR 24-HOUR URINE COLLECTION

Name: _____
 Sex: _____
 Test Request: _____
 Prescribe Agent: _____
 # of Urine Void: _____
 Test Values Observed: _____

Collection Starting Time: _____
 Collection Ending Time: _____

B350-4

Patient Instructions for Collecting a 24-Hour Urine Specimen

Important: To insure accurate test results, please follow these instructions carefully.

A) Ask your laboratory whether or not you should refrigerate this bottle during the collection period.
 B) At the hour you choose to start the collection period, urinate into a toilet and flush as usual.
 C) Record the starting time and date in the space provided below.
 D) For the next 24 hours, collect all your urine in this bottle.
 E) Do not urinate just when the 24 hour collection period ends and exclude this urine in the bottle.
 F) Record the ending time and date in the space provided below.
 G) Promptly bring the bottle back to the laboratory.

Collection Starting Time: _____
 Collection Ending Time: _____

B350-5

CAUTION!
 This bottle contains a strong preservative chemical. Do not breathe vapor. Do not spill or get on skin.

B350-6



Antistatic Weighing Dishes



D250

ANTISTATIC WEIGHING DISHES

Made of polystyrene

The Simport Weighing Dishes will resist diluted acids, aqueous solutions, alcohols and bases. They are ideal for many applications such as weighing, dispensing or storing. They are safe, contaminant-free, biologically inert, economical containers for weighing liquid or powdered samples in the laboratory. Flat bottoms ensures perfect stability on counters. They have a smooth surface providing accurate pour-outs with minimal sample loss and facilitating weighing of static-affected samples.

The Simport dishes can also be used as quick freeze trays for sample material, discard trays for broken ampoules, or mixing trays for small batches. Will withstand temperatures up to 80 °C.

Cat.#	Volume (ml)	Dimensions (mm)	Qty/Pk	Qty/Cs
D250-1	20	41 x 41 x 8 H	500	4000
D250-2	100	89 x 89 x 25 H	—	500
D250-3	330	140 x 140 x 25 H	—	500



D251

ANTISTATIC POUR BOATS

Made of polystyrene

These three sizes of pour boats are specially made to facilitate dispensing of powdered and liquid materials. Smooth, uniform and economical the molded material used is thicker than conventional weighing dishes. Can be used safely to weigh static-affected materials. Will withstand temperatures up to 80 °C.

Cat.#	Volume (ml)	Dimensions (mm)	Qty/Pk	Qty/Cs
D251-1	20	60 x 41 x 8 H	250	2000
D251-2	140	133 x 76 x 25 H	—	250
D251-3	270	197 x 121 x 25 H	—	250



D252

ANTISTATIC HEXAGONAL WEIGHING DISHES

Made of polystyrene

Excellent for handling solids or liquids during weighing. Easily bent into pouring spouts, the dishes enable non-spill transfer. Molded hexagonal design provides greater balance protection and safety. Not reactive with most substances. Suitable for weighing of static-affected samples. The dishes are stackable for easy storage. Will withstand temperatures up to 80 °C.

Cat.#	Volume (ml)	Top I.D. (mm)	Base I.D. (mm)	Qty/Pk	Qty/Cs
D252-1	20	38	25	500	4000
D252-2	50	64	51	—	500
D252-3	200	102	76	—	500
D252-4	350	127	89	—	500

B352

SPECIMEN BOTTLE

Made of polypropylene

Features a dip-stick well for small volume testing and a pour spout for dripless pouring. Translucent, with a stable square base. Can be autoclaved. Also useful as a drosophila stock bottle.

Graduated from 0 to 170 ml and from 0 to 6 oz.

Snap cap supplied separately (see B352-1).

Cat. #	Vol. (ml)	Size (mm)	Neck dia.	Qty/Cs
B352	170	55 x 55 x 102 H.	34	500

B352-1

SNAP CAP for B352 Specimen Bottle

Made of polyethylene

Cat. #	Outside dia.	Qty/Cs
B352-1	46 mm	2000

A GREAT DROSOPHILA STOCK BOTTLE



B352

B352-1



B700

TRICORN™ BEAKERS

Made of polypropylene

Tricorn™ beakers provide three dripless pouring spouts. Tough, unbreakable and suitable for use with commonly used acids, alkalies and solvents. Autoclavable.



If they fall, they will not break like glass beakers do.

SPECIAL FEATURES AND BENEFITS



A sturdy translucent reusable beaker that can be autoclaved, yet inexpensive enough to be disposable.



Dripless pouring spout offers more security.

Cat. #	Vol. (ml)	Graduations (ml)	Size (mm)	Qty/Cs
B700-50	50	5	49 x 57 H.	100
B700-100	100	10	58 x 72 H.	100
B700-250	250	10	76 x 90 H.	100
B700-400	400	20	85 x 108 H.	100
B700-800	800	50	107 x 133 H.	100
B700-1L	1000	50	115 x 145 H.	100

CONTAINERS

CONTAINERS

NEW

B720-13 & 16

SeraNest™

SAMPLE CUPS

Made of polystyrene

These sample cups will hold perfectly on top of blood collection tubes. Just pour the blood sample into a SeraNest and its low shoulder will hold securely on tube. No need to relabel. Two sizes available.

Cat. #	Dia.	Volume	Qty/Bag	Qty/Cs
B720-13	13 mm	1 ml	1000	5000
B720-16	16 mm	2 ml	1000	5000



SeraNest™ will hold securely on top of blood collection tubes.



AVAILABLE IN 2007

C200G

SputEm™ SPUTUM COLLECTION SYSTEM

Made of polypropylene

The ideal way to collect, carry and process biological samples. The unit features a base which already incorporates a removable sterile 50 ml graduated polypropylene conical tube that can withstand centrifugation up to 5000 RPM, or 3000g.

Available in a light green color, this unit is most attractive on a bedside table. Three narrow vertical windows allow the contents of the tube to be discreetly seen. A wide base ensures great stability and prevents tipping of the unit. The large collection funnel is made in such a way that specimens fall directly into the graduated centrifuge tube and do not contaminate the outside threads. The centrifuge tube screw cap is being kept sterile at all times under the snap cap on top of the funnel.

A patient label is already affixed on top of the unit and can easily be transferred to the tube before leaving for the laboratory. The base can be used as a support during transit. Each unit is sterile and individually wrapped.

Cat. #	Color	Qty/Cs
C200G	Green	72



BEFORE COLLECTION



- Remove from package.
- Fill out patient label.
- Lift the hinged lid.
- Avoid touching inside of funnel.
- Close lid after each use.

AFTER COLLECTION

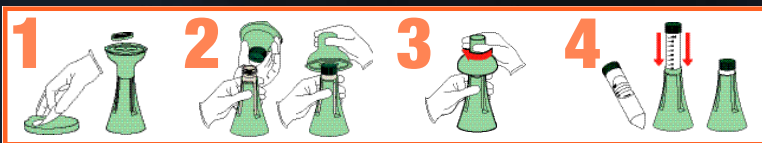

- Remove patient label and set it aside.
- Remove snap cap to expose sputum tube threaded cap.
- Remove funnel top and invert over tube.
- Squeeze middle part of Sputum Collection System and screw tube into threaded cap.
- Discard funnel top.
- Place patient label on side of tube.
- Place tube back in its base and send to lab.

C300 BIODISPOSER™

PORTABLE SHARPS DISPOSAL CONTAINERS

Made of polypropylene



1 liter phlebotomy size

These containers ensure safe and convenient disposal of blood collecting equipment, such as: hypodermic and IV needles, etc. Will safely sheath or unwind needles after use. Slot securely grips the needle hub, and a simple twist releases the needle from the holder, allowing it to fall into the container. This 1 liter container holds approximately 500 blood needles. Its flexible port design accommodates other disposal needs as well. This polypropylene container and cover can be flash autoclaved without melting. Available in two colors: red and yellow.

Dimensions: 8.89 cm x 8.89 cm x 15.24 cm H. (3 x 3 x 6 in. H.)

Cat. #	Color	Qty/Cs
C300-1R	Red	50
C300-1Y	Yellow	50

3 to 9 liter sizes

These uniquely designed larger units provide the safest method for discarding infectious waste. A two part assembly allows saving of storage space since bases and covers are stackable.

Blood needle removal is easy, using the unwinder. Capacity increased by 20 %, thanks to horizontal entry ports which position discarded objects for maximum space saving. Syringes with a volume of up to 60 ml can easily be inserted. Made of autoclavable polypropylene, they are also very resistant to piercing and shock. Each container has two openings with their own cover which is snapped shut securely when unit is ready to be discarded. Available in two colors.



A unique system of flaps combined with a tortuous path under the cover prevents objects from falling out, should the container turn over.

Posterior opening for large objects.

Anterior opening for horizontal loading.

Tortuous path design impedes hand entry.

Cat. #	Color	Capacity (L)	Dimensions	Qty/Cs
C300-3R	Red	3	25.08 x 16.19 x 13.65 cm H. / (9 7/8 x 6 3/8 x 5 3/8 in. H.)	20
C300-3Y	Yellow	3	25.08 x 16.19 x 13.65 cm H. / (9 7/8 x 6 3/8 x 5 3/8 in. H.)	20
C300-6R	Red	6	25.08 x 16.19 x 23.18 cm H. / (9 7/8 x 6 3/8 x 9 1/8 in. H.)	20
C300-6Y	Yellow	6	25.08 x 16.19 x 23.18 cm H. / (9 7/8 x 6 3/8 x 9 1/8 in. H.)	20
C300-9R	Red	9	25.08 x 16.19 x 32.07 cm H. / (9 7/8 x 6 3/8 x 12 5/8 in. H.)	20
C300-9Y	Yellow	9	25.08 x 16.19 x 32.07 cm H. / (9 7/8 x 6 3/8 x 12 5/8 in. H.)	20

CONTAINERS

**C570-12****NON STERILE DISPOSABLE SPECIMEN CONTAINER**

Polypropylene Container - Polyethylene Closure

Graduated. Heavy-duty thick wall construction of both container and lid ensures a positive leakproof seal time after time. The drip ring on the container reduces the chances of contamination.

Wide base design for stable reliable use. Molded-in graduations up to 128 ml / 4 oz. **Supplied non sterile** and packaged in bags of 100 stacked by 10's. Yellow caps packed separately in bags of 100.

Cat. #	Packaging	Qty/Cs
C570-12	Bags/100	500

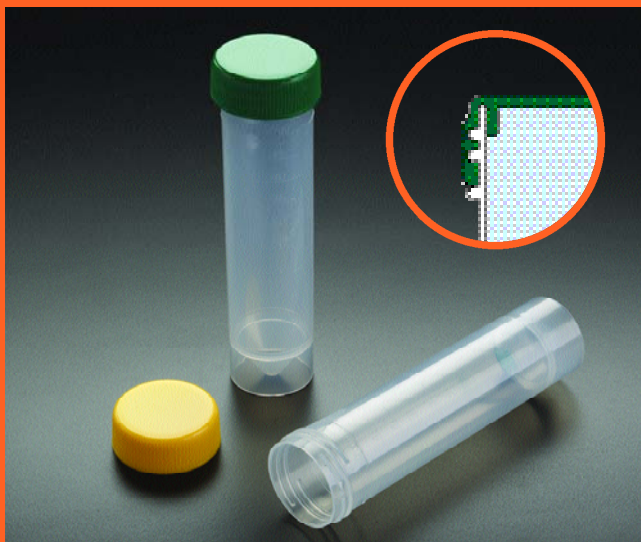
**C571****50ML SAMPLE TUBE**

Made of polypropylene

Conical bottom tubes with self-standing base graduated from 10 to 50 ml in 5 ml increments. Chemically resistant and shatterproof, they are supplied with a leakproof screw cap, particularly important when transporting hazardous material. Ideal for transport and storage of urine, sputum and most liquids or particulate samples. Molded-in graduations make them easy to read. Available sterile or non sterile. Functional temperature range: -90 °C to +121 °C.

Dimensions: 30 mm dia x 115 mm length.

Cat. #	Type	Color of cap	Qty/Bag	Qty/Cs
C571-1	Sterile	Green	25	500
C571-2	Non sterile	Yellow	100	500

B720-8**ANALYZER CUPS FOR HITACHI SYSTEMS 705-706-712**

Made of polystyrene

Capacity: 2 ml Diameter: 12.5 mm

Packaged in bags of 1000, case of 10,000

**B720-40****FIBRIN CUPS**

Made of polyethylene

Precision molded for constant volume and uniform heat transfer.

Capacity: 1.3 ml Packaged in bags of 1000, case of 10,000



C580

SPECIMEN CONTAINERS WITH SNAP CAP

These disposable containers made of high density polyethylene, are ideal for collection and storage of fluids, powders, solids, pathology specimens and hazardous samples. Lids are tight fitting and leakproof. The two larger sizes are supplied with a plastic handle for easier carrying, and a tamperproof lid which is opened by first removing tab on side of lid, then by lifting the cover.

Lids: LDPE

Containers: PP

Cat. #	(ml/oz)	Opening (mm)	Height (mm)	Qty/Cs
C580-3	300/10	111	45	100
C580-4	500/17	111	75	100
C580-5	1000/34	111	140	100



The 2250 and 5500 ml sizes are provided with a plastic handle to facilitate handling.

C581

TAMPERPROOF SPECIMEN CONTAINERS

Made of Polypropylene

These disposable containers are ideal for collection, transport and storage of fluids, powders, solids, pathology specimens and hazardous samples. Tight-fitting lids prevent leaks and odors. They incorporate a tamperproof lid which is opened by first removing tab on side of lid, then by lifting the cover. They resist temperatures up to 121 °C. The two larger sizes are supplied with a plastic handle for easy carrying.

Cat. #	(ml/oz)	Opening (mm)	Height (mm)	Qty/Cs
C581-300	300/10	111	45	100
C581-500	500/17	111	75	100
C581-1L	1000/34	111	140	100
C581-2L	2500/80	150	168	25
C581-5L	5500/170	215	190	10

TAMPERPROOF SPECIMEN CONTAINERS ARE EASY TO OPEN



Pull on tab and remove to break the tamperproof seal.

Simply lift cover.